

Rectangular Rapid Flashing Beacon (RRFB)

Pedestrian Safety System
Single or Double Sided
Solar-Powered, Wireless Control Option

Cabinets
Controllers
Signals
Signs
Software
Specialty



Overview

McCain's Rectangular Rapid Flashing Beacon (RRFB) is an effective means of boosting driver awareness and adherence to road signs, drastically promoting motorist and pedestrian safety. An ideal solution for a range of applications, RRFBs are rapidly gaining popularity as an inexpensive and effective alternative for improving driver compliance and facilitating pedestrian crossings at unsignalized intersections and mid-block crosswalks; generally delivering driver compliance upwards of 80%.

Benefits

- Improve pedestrian safety
- Boost driver awareness and compliance
- Command attention 24 hours a day with highly visible, high-intensity LEDs
- Adhere to MUTCD and FHWA specifications
- Use for new or existing pedestrian crossings
- Save energy when using the solar-powered wireless control option

Product Description

The McCain RRFB, available in single or double-sided versions, is designed to increase safety at locations that pose critical concerns, such as schools, roundabouts, and multi-lane crosswalks.

Easy to install and maintain, the RRFB remains dark until activated by a pedestrian. When activated, high-intensity LEDs flash in a wig-wag pattern as specified by the FHWA.

McCain's RRFB offers flexible configuration options and modes of operations, including flashing, delay, and trailing times up to 99 seconds.

Power-saving solar option with wireless control available.

RRFB

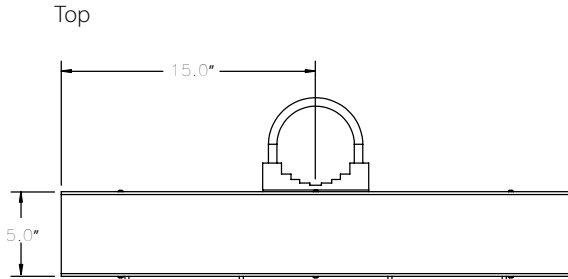
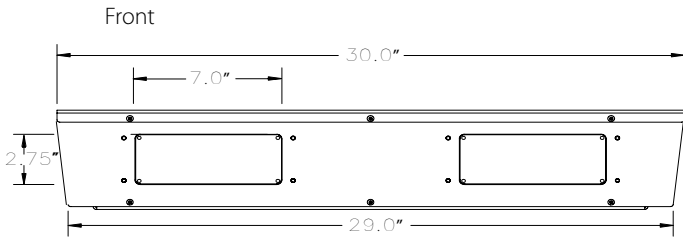

Back

Single-Sided

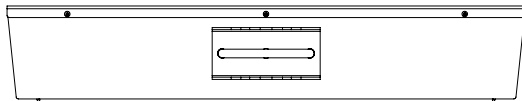

Double-Sided

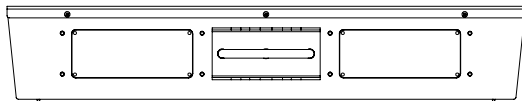

Left Side

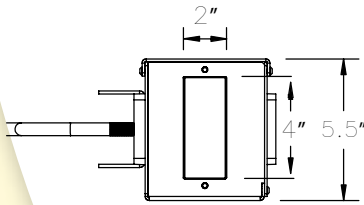

Dimensions rounded to the nearest 0.1"

Standard Features

- User selectable, high-intensity LEDs flash in FHWA-approved patterns: 2-5, WW+S, and blocks
- Selectable modes of operation with delay and trailing times
- LED modules
 - » Single-sided: 3 amber LED modules (2 front, 1 side)
 - » Double-sided: 6 amber LED modules (2 front, 2 side, 2 back)
- All settings pre-programmed via internal switches (4)
- Pedestrian pushbutton failure and testing modes
- MUTCD compliant
- Compatible with advisor guidance accessible pedestrian signals (AGPS)

General Specifications*

Dimensions:	30" L x 5.5" H x 5" D (rounded to nearest 0.1")	
Material:	5052-H32 aluminum, 0.100" thick	
Finish(es):	Powder coated	
Color(s):	Federal yellow, black, natural finish Custom colors available	
Access:	Removable top panel with tamper resistant hardware	
Mounting:	Stainless steel u-bolts for 4" to 4.5" pole	
Power Supply:	100 ~ 240 VAC at 50/60 Hz	
	w/ Solar:	Wireless solar-powered board installed to enable the unit to draw power from the sun
Load Current:	<u>Single-Sided</u>	<u>Double-Sided</u>
(When Flashing)	Max	2.6A@12VDC 5.1A@12VDC
	Avg	1.6A@12VDC 3.1A@12VDC
	Typical	0.85A@12VDC 1.6A@12VDC
(Standby)	< 0.05A@12VDC	
Environmental:	Operating Temperature: -37° to +74° C Humidity: 0 to 95% (non-condensing)	
Shipping Weight:	12 lbs	

* Specifications listed are for the RRFB only. Weights and measurements for additional solar-powered wireless components vary by set-up.

Part Numbers

M49158	Single-sided RRFB
M49158W	Single-sided RRFB solar-powered with wireless digital input/output
M49153	Double-sided RRFB
M49153W	Double-sided RRFB solar-powered with wireless digital input/output

Options

- Reflective sheeting for maximum nighttime brightness and visibility

To learn more about McCain's Integrated Traffic Solutions, please contact info@mccain-inc.com or call (760) 727-8100

